

Event 1 - Stair Climb
(off air)
FF will climb stairs five times (up/down = 1 climb) with high rise pack on shoulder

Event 7 - Rescue
(on air)
FF shall drag Rescue Randy (180 lbs) a total of 70' (35' around a barrel and back 35')

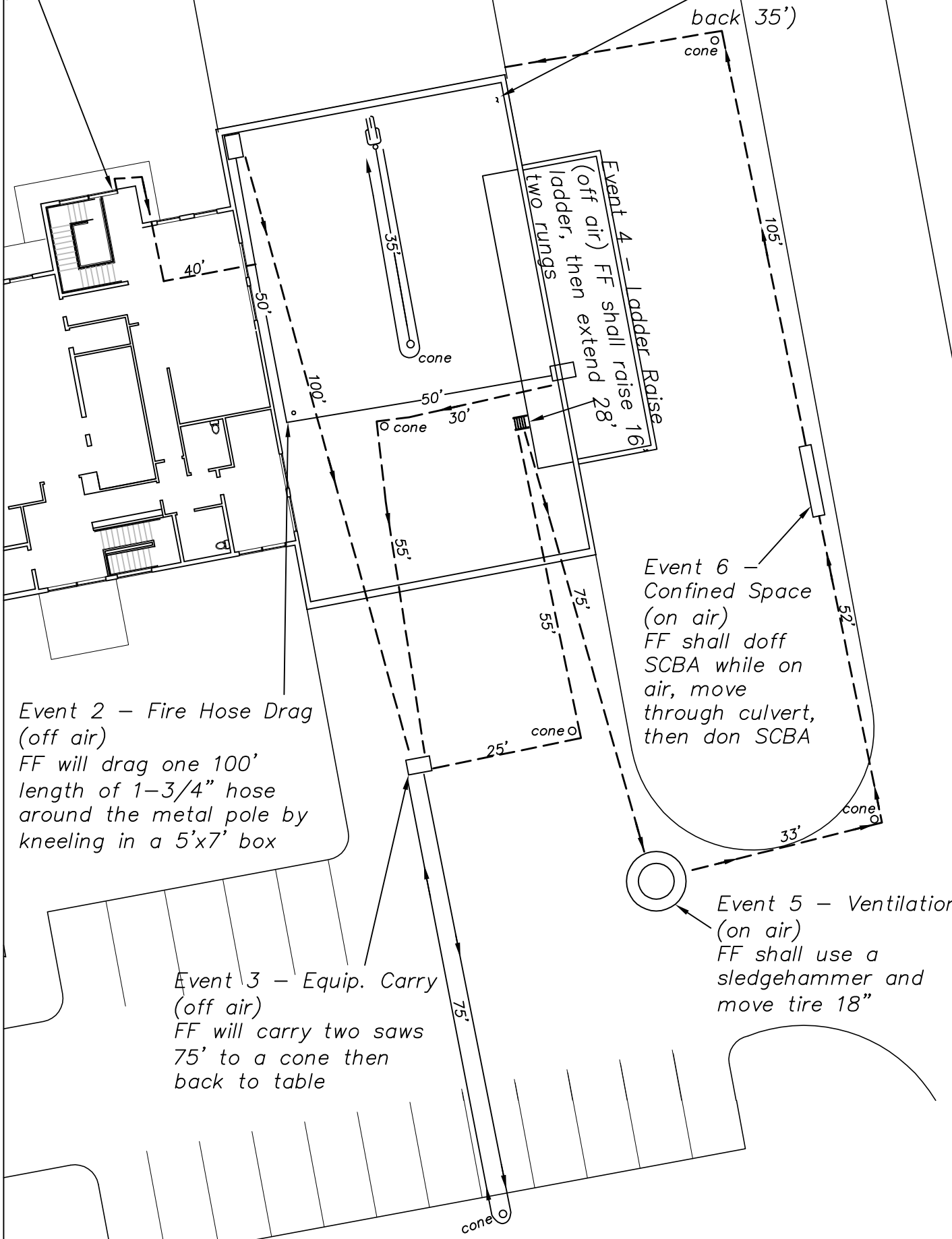

Event 2 - Fire Hose Drag
(off air)
FF will drag one 100' length of 1-3/4" hose around the metal pole by kneeling in a 5'x7' box

Event 4 - Ladder Raise
(off air) FF shall raise 16' ladder, then extend 28' two rungs

Event 6 - Confined Space
(on air)
FF shall doff SCBA while on air, move through culvert, then don SCBA

Event 3 - Equip. Carry
(off air)
FF will carry two saws 75' to a cone then back to table

Event 5 - Ventilation
(on air)
FF shall use a sledgehammer and move tire 18"